









ENSURE PROTECTION OF TREES AND TREE PROTECTION ZONES FOR ALL TREES NOTE MARKED FOR REMOVAL, TO AS4970 2009.

LEGEND

-  Perimeter Fence
-  Concrete Pavement as Detailed 02/L-600
-  Decomposed Granite Gravel as Detailed 01/L-600
-  Brick Paving as Detailed 03/L-600
-  Poured Rubber Sofffall as Detailed 09/L-600
-  Play Sand as Detailed 05/L-600
-  Mulch Sofffall as Detailed 07/L-600
-  Concrete Edge as Detailed 04/L-600
-  Proposed Contours
- x EL 330.200 Existing Levels
- x RL 330.200 Proposed Levels

sala4D

landscape architecture · urban design

LANDSCAPE ARCHITECT

© sala4D 2024 All rights reserved.

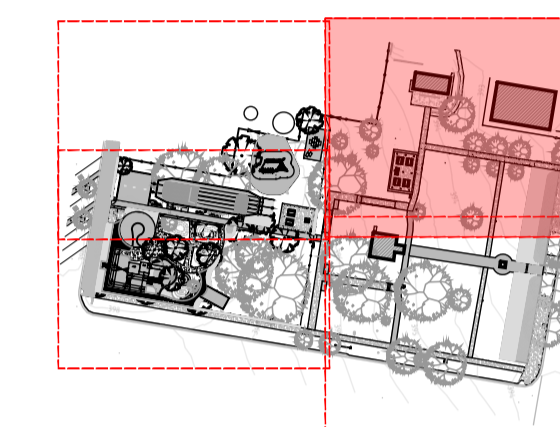

KEY PLAN

DATE	DESCRIPTION	REV
18/02/25	Revised tender	A
-	-	-
-	-	-
-	-	-
-	-	-
-	-	-
-	-	-
-	-	-

REVISIONS

Weddin Shire Council
73 Camp Street
Grenfell, NSW 2810

CLIENT

ARCHITECT

TAYLOR PARK
Weddin Street
Grenfell, NSW 2810

PROJECT

TENDER DOCUMENTATION

PURPOSE OF DRAWING

**HARDWORKS
SURFACE FINISHES, GRADING AND
SETOUT PLAN**

DRAWING TITLE



NORTH SCALE BAR

SCALE	1:100 @ A1	DRAWN BY	XS
DATE	18/02/2025	CHECKED BY	SA
JOB NO.	-	APPROVED BY	SA

DRAWING NO.	REVISION
L-301	A

DRAWING INFORMATION

